

SUN LOFT 47

Linnea (2020)

Sailing yacht Sun Loft 47 Linnea, built in 2020 is anchored in the BVI, Tortola, Nanny Cay Marina, British Virgin Islands, British Virgin Islands. It has 6 + 1 cabins, can accommodate 12 + 1 people and has 4 + 1 toilets. Bed linen and kitchen equipment are included in the price.

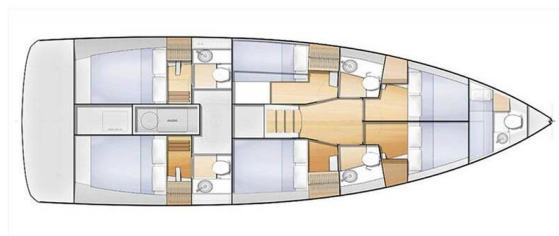

YACHT SPECIFICATIONS

Yacht Base

**BVI, Tortola, Nanny Cay Marina,
British Virgin Islands**

Yacht ID

2143

Brands

Jeanneau

Yacht name

Linnea

Production year

2020

Length

47 ft

Cabins

6 + 1

Berths

12 + 1

Max Persons

14

WC

4 + 1

Engine

1 x 80 HP

Fuel tank

240 l



WEBSITE

www.plujeme.cz



PHONE

+420 720 755 085



MOBILE

+420 777 170 276



E-MAIL

info@plujeme.cz



PLUJEME RÁDI S.R.O.

Dlouhá 730/35, 11000 Praha 1 – Staré Město, Czech Republic

STANDARD YACHT EQUIPMENT

Additional	Flag
Comfort	Blankets, Cockpit cushions, Mattresses, Pillows, Sheets, Sun mattresses
Deck	Anchor with chain, Bilge pump - Mechanic, Bimini top, Boat hook, Bosun's chair (Safe seat) (boatswain's chair), Cockpit fridge, Cockpit grill, Cockpit table, Cockpit/stern, outside shower, Deck brush, Deck lights, Diesel filter, Dinghy with outboard engine, Fenders, Fuel funnel, Galley in cockpit, Gangway, Hot water in cockpit, Jerry cans for fuel, Plastic bucket, Round/globular fender, Spare anchor (Reserve, Auxiliary anchor), Sponge, Sprayhood, Swimming ladder, Water hose
Entertainment	Fins, Fusion radio, Mask and snorkel
Galley	Blender, Electrical filter coffee maker, Gas bottles, Kitchen towel, Kitchen utensils (Galley equipment, cutlery), Microwave, Refrigerator, Sink, Toaster, Water pump
Interior	Clothes hangers, Electric fans in cabins, LED interior lights, Toilet brush
Navigation	Binoculars, Bow thruster, Compass, GPS chart plotter, Log, Nautical charts, Navigation set, Navigation/position Lights, Radar reflector, Raymarine navsystem (Tridata, Echo, Wind), Windex
Safety	Distress flare box, Emergency tiller, Engine spare parts , Fire extinguisher , First aid kit , Flashlight, Fog horn, Inflatable life raft, Life belts (Safety harness), Liferaft , Set of tools , Torch, Wire (shroud) cutter
Sails	Self tacking jib, Winch
Yacht electrics	Air Conditioning, Batteries, Battery charger , Bilge pump - Electric, Generator, Inverter, Motor hours counter, Service batteries, Shore power cable, USB sockets, Water heater



WEBSITE
www.plujeme.cz



PHONE
+420 720 755 085



MOBILE
+420 777 170 276



E-MAIL
info@plujeme.cz



PLUJEME RÁDI S.R.O.
Dlouhá 730/35, 11000 Praha 1 – Staré Město, Czech Republic

SERVICES

SELECTED SERVICES	OBLIGATORY	PAYMENT TYPE	PRICE
Cruising tax (Payable now) Season: 2024 . BVI: Cruising tax payable in advance: 4 USD per person / day (Price will be adjusted when the option is confirmed)	Yes	per guest/day	3,48 €
Navigare Carefree (Payable now) Season: 2024 . *** To be added upon client's price - OBLIGATORY - BVI - SY up to 49 ft - Includes damage waiver insurance/full coverage* - NEW!, welcome package, final cleaning, bed sheets & towels, dinghy, outboard engine & fuel, propane gas, full water tanks, snorkelling equipment, National parks permits, and VISAR. Beach towels are provided 1 per person for the charter. Yacht Fuel is not included - the fuel tank will be full when your charter starts and you are responsible for topping off the fuel tank at the end of your charter. ***** CRUISING TAX is NOT INCLUDED.	Yes	per booking	650,00 €
Navigare Carefree surcharge for two/more weeks (Payable now) Season: 2024 . Damage waiver insurance, bed linen & towels/ obligatory - will only be added to a charter with a duration between 14 and 20 days	Yes	per 2 weeks	170,00 €
Navigare Carefree surcharge for two/more weeks (Payable now) Season: 2024 . Damage waiver insurance, bed linen & towels/ obligatory will only be added to a charter with a duration between 21 and 27 days	Yes	per 3 weeks	320,00 €
Navigare Carefree surcharge for two/more weeks (Payable now) Season: 2024 . Damage waiver insurance, bed linen & towels/ obligatory - will only be added to a charter with a duration of 28+ days	Yes	per 4 weeks and more	470,00 €
Cruising tax (Payable now) Season: 2025 . BVI: Cruising tax payable in advance: 4 USD per person / day (Price will be adjusted when the option is confirmed)	Yes	per guest/day	3,48 €
Navigare Carefree (Payable now) Season: 2025 . *** To be added upon client's price - OBLIGATORY - BVI - SY up to 49 ft - Includes damage waiver insurance/full coverage* - NEW!, welcome package, final cleaning, bed sheets & towels, dinghy, outboard engine & fuel, propane gas, full water tanks, snorkelling equipment, National parks permits, and VISAR. Beach towels are provided 1 per person for the charter. Yacht Fuel is not included - the fuel tank will be full when your charter starts and you are responsible for topping off the fuel tank at the end of your charter. ***** CRUISING TAX is NOT INCLUDED.	Yes	per booking	650,00 €

Navigare Carefree surcharge for two/more weeks (Payable now) Season: 2025. Damage waiver insurance, bed linen & towels/ obligatory - will only be added to a charter with a duration between 14 and 20 days	Yes	per 2 weeks	185,00 €
Navigare Carefree surcharge for two/more weeks (Payable now) Season: 2025. Damage waiver insurance, bed linen & towels/ obligatory - will only be added to a charter with a duration between 21 and 27 days	Yes	per 3 weeks	350,00 €
Navigare Carefree surcharge for two/more weeks (Payable now) Season: 2025. Damage waiver insurance, bed linen & towels/ obligatory - will only be added to a charter with a duration of 28+ days	Yes	per 4 weeks and more	515,00 €
Checkout Skipper (Payable now) Season: 2024 . A check-out skipper (COS) is a professional captain that boards with you on Day 1, and is dropped off late afternoon the same day. A COS may be requested by you or may be required by Navigare after review of your sailing resume.	Yes	per booking	305,00 €
Cook (Payable now) Season: 2024 . Cook requires own cabin with a toilet and shower + food (not peak cabin). A gratuity of 15-20% of the crew fee is customary for excellent service. Cooking breakfast, lunch, dinners, supply, keeping the kitchen clean (not the rest of the boat, not the cabins). *** NOTE: Cook details will be available 3 days before charter.	Yes	per day + food	220,00 €
Sailing Instructor (Payable now) Season: 2024 . Sailing instructor BVI	Yes	per day + food	350,00 €
Skipper (Payable now) Season: 2024 . Skipper requires standard cabin with access to a toilet and shower + food (not peak skipper cabin). A gratuity of 15-20% of the crew fee is customary for excellent service ***NOTE: Skipper details will be available 3 days before the charter.	Yes	per day + food	270,00 €
Sleep over before check in (Payable now) Season: 2024 . Sleep over on a day before the check-in: Sleep over from 5PM on a day before the check-in date and time stated in the contract: 65% of the daily rate. (Price will be adjusted when the option is confirmed)	Yes	per booking	1.000,00 €
WIFI package (Payable now) Season: 2024 . Unlimited Wifi / BVI / BAH / USVI	Yes	per booking	130,44 €

Checkout Skipper (Payable now)	Yes	per booking	370,00 €
Season: 2025. A check-out skipper (COS) is a professional captain that boards with you on Day 1, and is dropped off late afternoon the same day. A COS may be requested by you or may be required by Navigare after review of your sailing resume.			
Cook (Payable now)	Yes	per day + food	240,00 €
Season: 2025. Cook requires standard cabin with access to a toilet and shower + food. A gratuity of 15-20% of the crew fee is customary for excellent service. Cooking breakfast, lunch, dinners, and supplies, keeping the kitchen clean (not the rest of the boat, not the cabins). ***NOTE: Cook details will be available 3 days before the charter.			
Sailing Instructor (Payable at the base)	Yes	per day + food	350,00 €
Season: 2025. Sailing instructor BVI			
Skipper (Payable now)	Yes	per day + food	295,00 €
Season: 2025. Skipper requires standard cabin with access to a toilet and shower + food (not peak skipper cabin). A gratuity of 15-20% of the crew fee is customary for excellent service ***NOTE: Skipper details will be available 3 days before the charter.			
Sleep over before check in (Payable now)	Yes	per booking	1.000,00 €
Season: 2025. Sleep over on a day before the check-in: Sleep over from 5PM on a day before the check-in date and time stated in the contract: 65% of the daily rate. (Price will be adjusted when the option is confirmed)			
WIFI package (Payable now)	Yes	per booking	130,44 €
Season: 2025. Unlimited Wifi / BVI / BAH / CAR			



WEBSITE

www.plujeme.cz



PHONE

+420 720 755 085



MOBILE

+420 777 170 276



E-MAIL

info@plujeme.cz



PLUJEME RÁDI S.R.O.

Dlouhá 730/35, 11000 Praha 1 – Staré Město, Czech Republic

ADDITIONAL EXTRAS

EXTRA	OBLIGATORY	PAYMENT TYPE	PRICE
Railing net (Safety net) (Payable now) Season: 2024 . Railing net - mounting not included. Clients must mount the railing net (safety net) by themselves (On request - LIMITED NUMBER) - Payable now	Yes	per booking	142,00 €
Stand up paddle (SUP) (Payable now) Season: 2024 . Payable now	Yes	per day	20,00 €
Railing net (Safety net) (Payable now) Season: 2025 . mounting not included - Payable now	Yes	per booking	155,00 €
Stand up paddle (SUP) (Payable now) Season: 2025 . Payable now	Yes	per day	20,00 €



WEBSITE
www.plujeme.cz



E-MAIL
info@plujeme.cz



PHONE
+420 720 755 085



PLUJEME RÁDI S.R.O.
Dlouhá 730/35, 11000 Praha 1 – Staré Město, Czech Republic



MOBILE
+420 777 170 276

PRICE AND AVAILABILITY

12.10. - 19.10.2024 2.677 € 4.780 €	19.10. - 26.10.2024 2.677 € 4.780 €	26.10. - 02.11.2024 2.677 € 4.780 €	02.11. - 09.11.2024 3.059 € 4.780 €
09.11. - 16.11.2024 3.059 € 4.780 €	16.11. - 23.11.2024 3.994 € 6.240 €	24.11. - 05.12.2024 NOT AVAILABLE	07.12. - 14.12.2024 3.619 € 6.240 €
14.12. - 21.12.2024 5.777 € 9.960 €	21.12. - 28.12.2024 9.960 €	04.01. - 15.01.2025 NOT AVAILABLE	18.01. - 25.01.2025 5.950 € 7.000 €
25.01. - 30.01.2025 ON OPTION	30.01. - 08.02.2025 NOT AVAILABLE	08.02. - 15.02.2025 6.851 € 8.060 €	15.02. - 22.02.2025 6.851 € 8.060 €
22.02. - 01.03.2025 6.851 € 8.060 €	01.03. - 08.03.2025 6.851 € 8.060 €	09.03. - 16.03.2025 NOT AVAILABLE	22.03. - 29.03.2025 6.851 € 8.060 €
29.03. - 05.04.2025 7.395 € 8.700 €	05.04. - 12.04.2025 7.395 € 8.700 €	12.04. - 19.04.2025 5.780 € 6.800 €	19.04. - 26.04.2025 5.780 € 6.800 €
26.04. - 03.05.2025 5.780 € 6.800 €			



WEBSITE
www.plujeme.cz



E-MAIL
info@plujeme.cz



PHONE
+420 720 755 085



PLUJEME RÁDI S.R.O.
Dlouhá 730/35, 11000 Praha 1 – Staré Město, Czech Republic



MOBILE
+420 777 170 276

PRICE AND AVAILABILITY

03.05. - 10.05.2025 5.780 € 6.800 €	10.05. - 17.05.2025 4.633 € 5.450 €	17.05. - 24.05.2025 4.633 € 5.450 €	24.05. - 31.05.2025 4.633 € 5.450 €
31.05. - 07.06.2025 4.633 € 5.450 €	10.06. - 27.06.2025 NOT AVAILABLE	28.06. - 05.07.2025 3.553 € 4.180 €	05.07. - 12.07.2025 3.553 € 4.180 €
12.07. - 19.07.2025 3.553 € 4.180 €	19.07. - 26.07.2025 3.553 € 4.180 €	26.07. - 02.08.2025 3.553 € 4.180 €	04.08. - 10.10.2025 NOT AVAILABLE
11.10. - 18.10.2025 3.553 € 4.180 €	18.10. - 25.10.2025 3.553 € 4.180 €	25.10. - 01.11.2025 3.553 € 4.180 €	01.11. - 08.11.2025 3.553 € 4.180 €
08.11. - 15.11.2025 3.553 € 4.180 €	15.11. - 22.11.2025 3.553 € 4.180 €	22.11. - 29.11.2025 4.633 € 5.450 €	29.11. - 06.12.2025 4.633 € 5.450 €
06.12. - 13.12.2025 4.633 € 5.450 €	13.12. - 20.12.2025 4.633 € 5.450 €	20.12. - 27.12.2025 8.700 €	



WEBSITE

www.plujeme.cz



E-MAIL

info@plujeme.cz



PHONE

+420 720 755 085



MOBILE

+420 777 170 276



PLUJEME RÁDI S.R.O.

Dlouhá 730/35, 11000 Praha 1 – Staré Město, Czech Republic