

OCEANIS 51.1

Brando (2019)

Sailing yacht **Oceanis 51.1 Brando**, built in **2019** is anchored in the **Lefkas, D-Marin, Ionian Islands, Greece**. It has **5 + 1 cabins**, can accommodate **10 + 1 people** and has **3 + 1 toilets**. Bed linen and kitchen equipment are included in the price.

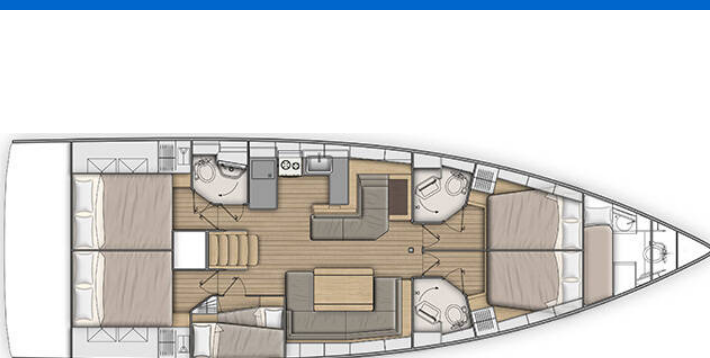

YACHT SPECIFICATIONS

Yacht Base

Lefkas, D-Marin, Greece

Yacht ID

1490

Brands

Beneteau

Yacht name

Brando

Production year

2019

Length

52 ft

Cabins

5 + 1

Berths

10 + 1

Max Persons

12

WC

3 + 1

Engine

1 x 110 HP

Fuel tank

400 l



WEBSITE

www.plujeme.cz



PHONE

+420 720 755 085



MOBILE

+420 777 170 276



E-MAIL

info@plujeme.cz



PLUJEME RÁDI S.R.O.

Dlouhá 730/35, 11000 Praha 1 – Staré Město, Czech Republic

STANDARD YACHT EQUIPMENT

Comfort	Blankets, Cockpit cushions, Pillows, Sheets, Towels
Deck	Anchor with chain, Bilge pump – Mechanic, Bimini top, Black ball, Boat hook, Canister for water, Cockpit table, Dinghy, Dinghy (byboat) pump, Electric anchor windlass, Fenders, Fuel funnel, Gangway, Jerry cans for diesel, Mooring ropes , Outboard engine, Plastic bucket, Repair box for dinghy, Spare anchor (Reserve, Auxiliary anchor), Sprayhood, Swimming ladder, Teak cockpit, Winch handles
Entertainment	Bluetooth player, Outdoor speakers, Snorkeling equipment, TV + DVD
Galley	Gas bottles, Kitchen utensils (Galley equipment, cutlery), Oven, Refrigerator, Stove
Interior	Bilge pump handle, Convertible table in salon, Electric fans in cabins, Electric toilet, Yacht documents
Navigation	Autopilot, Bow thruster, Compass, Divider, nautic chart, Echosounder/Depthsounder, GPS chart plotter - cockpit, Hand bearing compass, Parallel ruler, Pilot book, Radar reflector, Speedometer (Speed log), Wind instrument/Anemometer
Safety	Emergency tiller, Engine spare parts , Fire extinguisher , First aid kit , Floating light, Fog horn, Horseshoe lifebuoy, Life belts (Safety harness), Life jackets, Liferaft , Oars (Paddles), Repair kit, Set of tools , Torch
Yacht electrics	220V socket, Air Conditioning, Batteries, Battery charger , Generator, Inverter, Solar panels, USB sockets



WEBSITE

www.plujeme.cz



PHONE

+420 720 755 085



MOBILE

+420 777 170 276



E-MAIL

info@plujeme.cz



PLUJEME RÁDI S.R.O.

Dlouhá 730/35, 11000 Praha 1 – Staré Město, Czech Republic

SERVICES

SELECTED SERVICES	OBLIGATORY	PAYMENT TYPE	PRICE
Starter pack (Payable at the base) Season: 2024. End cleaning, 1x Cooking gas, Water, Linen 1 set (2 sheets, 1 pillow case, 1 bath towel) per person, Harbour fees for the first & last night. * If there is pet on board, then double cleaning will be applied.; Payable on the spot with cash 🇪🇺 bag with Greek Local Products is offered to all of our charters as a welcome gift.	Yes	per booking	300,00 €
Starter pack (Payable at the base) Season: 2025. End cleaning, 1x Cooking gas, Water, Linen 1 set (2 sheets, 1 pillow case, 1 bath towel) per person, Harbour fees for the first & last night. * If there is pet on board, then double cleaning will be applied.; Payable on the spot with cash 🇪🇺 bag with Greek Local Products is offered to all of our charters as a welcome gift.	Yes	per booking	300,00 €
Crew change (Payable at the base) Season: 2024. Payable on the spot with cash	Yes	per booking	150,00 €
Early boarding/check-in (Payable at the base) Season: 2024. Access to the yacht by 14:00 In the event of delay beyond our control refunds will be made.; Payable on the spot with cash	Yes	per booking	150,00 €
Hostess (Payable at the base) Season: 2024. or 190€ / day for more than 10 pax. *crew require their own cabin; Payable on the spot with cash Down payment is required and 25% charge applicable if crew is cancelled less than 4 weeks before embarkation. 100% charge applicable If crew is cancelled less than 14 days prior to embarkation	Yes	per day + food	170,00 €
Internet pack (Payable at the base) Season: 2024. +20 € per week after the 1st (WiFi hotspot for up to 5 devices and unlimited usage of internet); Payable on the spot with cash	Yes	per booking	70,00 €
Linen Pack (Payable at the base) Season: 2024. 1 Extra set of linen (2 sheets, 1 pillow case, 1 bath towel); Payable on the spot with cash	Yes	per set	15,00 €

Non refundable deposit/ insurance (Payable at the base) Season: 2024. + refundable deposit 700 EUR; non refundable payable on spot in cash and refundable payable by credit card on spot. Charter Company reserves the right not to accept this option due to weather conditions or skipper's incompetence.	Yes	per booking	400,00 €
Skipper (Payable at the base) Season: 2024. (Crew require their own cabin); Payable on the spot with cash Down payment is required and 25% charge applicable if crew is cancelled less than 4 weeks before embarkation. 100% charge applicable if crew is cancelled less than 14 days prior to embarkation	Yes	per day + food	190,00 €
Welcome package (Payable at the base) Season: 2024. Toilet and Kitchen rolls, matches, Plastic bags for rubbish, 1 Dish Sponge, 1 Dish, Soap, Sugar, Salt and Pepper, Coffee, 6 bottles of Water, 1 bottle of wine, 6 cans of Coke, 6 cans of Beer, Milk, Orange Juice; Payable on the spot with cash	Yes	per booking	70,00 €
Crew change (Payable at the base) Season: 2025. Payable on the spot with cash	Yes	per booking	150,00 €
Early boarding/check-in (Payable at the base) Season: 2025. Access to the yacht by 14:00 In the event of delay beyond our control refunds will be made.; Payable on the spot with cash	Yes	per booking	150,00 €
Hostess (Payable at the base) Season: 2025. or 190€ / day for more than 10 pax. *crew require their own cabin; Payable on the spot with cash Down payment is required and 25% charge applicable if crew is cancelled less than 4 weeks before embarkation. 100% charge applicable if crew is cancelled less than 14 days prior to embarkation	Yes	per day + food	170,00 €
Internet pack (Payable at the base) Season: 2025. +20 € per week after the 1st (WiFi hotspot for up to 5 devices and unlimited usage of internet); Payable on the spot with cash	Yes	per booking	70,00 €
Linen Pack (Payable at the base) Season: 2025. 1 Extra set of linen (2 sheets, 1 pillow case, 1 bath towel); Payable on the spot with cash	Yes	per set	15,00 €
Non refundable deposit/ insurance (Payable at the base) Season: 2025. + refundable deposit 700 EUR; non refundable payable on spot in cash and refundable payable by credit card on spot. Charter Company reserves the right not to accept this option due to weather conditions or skipper's incompetence.	Yes	per booking	400,00 €

Skipper (Payable at the base)

Yes

per day + food

190,00 €

Season: 2025. (Crew require their own cabin); Payable on the spot with cash Down payment is required and 25% charge applicable if crew is cancelled less than 4 weeks before embarkation. 100% charge applicable if crew is cancelled less than 14 days prior to embarkation

Welcome package (Payable at the base)

Yes

per booking

70,00 €

Season: 2025. Toilet and Kitchen rolls, matches, Plastic bags for rubbish, 1 Dish Sponge, 1 Dish, Soap, Sugar, Salt and Pepper, Coffee, 6 bottles of Water, 1 bottle of wine, 6 cans of Coke, 6 cans of Beer, Milk, Orange Juice; Payable on the spot with cash



WEBSITE

www.plujeme.cz



PHONE

+420 720 755 085



MOBILE

+420 777 170 276



E-MAIL

info@plujeme.cz



PLUJEME RÁDI S.R.O.

Dlouhá 730/35, 11000 Praha 1 – Staré Město, Czech Republic

ADDITIONAL EXTRAS

EXTRA	OBLIGATORY	PAYMENT TYPE	PRICE
Automatic Inflatable Life Jacket (Payable at the base) Season: 2024. Payable on the spot with cash - Payable at the base	Yes	per week/ person	30,00 €
Beach towel (Payable at the base) Season: 2024. Payable on the spot with cash - Payable at the base	Yes	per piece	5,00 €
Electric outboard engine (Payable at the base) Season: 2024. 3 HP - Payable at the base	Yes	per week	120,00 €
Kayak (Payable at the base) Season: 2024. Payable on the spot with cash - Payable at the base	Yes	per week	130,00 €
Life jacket (children) (Payable at the base) Season: 2024. for children under 25 kg, one included in every yacht free of charge; Payable on the spot with cash - Payable at the base	Yes	per week/ person	20,00 €
Railing net (Safety net) (Payable at the base) Season: 2024. 200 € for yachts up to 46 ft., 260 € per week for yachts above 46ft & catamarans (Half price if the railing net is supplied uninstalled). Payable on the spot with cash - Payable at the base	Yes	per week	260,00 €
Railing net (Safety net) (Payable at the base) Season: 2024. 200 € for yachts up to 46 ft., 260 € per week for yachts above 46ft & catamarans (Half price if the railing net is supplied uninstalled). Payable on the spot with cash - Payable at the base	Yes	per week	260,00 €
SEA-D00 underwater scooter (Payable at the base) Season: 2024. Payable on the spot with cash - Payable at the base	Yes	per week	150,00 €
Stand up paddle (SUP) (Payable at the base) Season: 2024. Payable on the spot with cash - Payable at the base	Yes	per week	130,00 €
Automatic Inflatable Life Jacket (Payable at the base) Season: 2025. Payable on the spot with cash - Payable at the base	Yes	per week/ person	30,00 €
Beach towel (Payable at the base) Season: 2025. Payable on the spot with cash - Payable at the base	Yes	per piece	5,00 €
Electric outboard engine (Payable at the base) Season: 2025. 3 HP - Payable at the base	Yes	per week	120,00 €

Kayak (Payable at the base)	Yes	per week	130,00 €
Season: 2025. Payable on the spot with cash - Payable at the base			
Life jacket (children) (Payable at the base)	Yes	per week/ person	20,00 €
Season: 2025. for children under 25 kg, one included in every yacht free of charge; Payable on the spot with cash - Payable at the base			
Railing net (Safety net) (Payable at the base)	Yes	per week	260,00 €
Season: 2025. 200 € for yachts up to 46 ft., 260 € per week for yachts above 46ft & catamarans (Half price if the railing net is supplied uninstalled). Payable on the spot with cash - Payable at the base			
SEA-DOO underwater scooter (Payable at the base)	Yes	per week	150,00 €
Season: 2025. Payable on the spot with cash - Payable at the base			
Stand up paddle (SUP) (Payable at the base)	Yes	per week	130,00 €
Season: 2025. Payable on the spot with cash - Payable at the base			



WEBSITE

www.plujeme.cz



E-MAIL

info@plujeme.cz



PHONE

+420 720 755 085



MOBILE

+420 777 170 276



PLUJEME RÁDI S.R.O.

Dlouhá 730/35, 11000 Praha 1 – Staré Město, Czech Republic

PRICE AND AVAILABILITY

21.09. - 28.09.2024 NOT AVAILABLE	28.09. - 05.10.2024 NOT AVAILABLE	05.10. - 12.10.2024 NOT AVAILABLE	12.10. - 19.10.2024 NOT AVAILABLE
19.10. - 26.10.2024 NOT AVAILABLE	26.10. - 02.11.2024 1.800 € 4.780 €	02.11. - 09.11.2024 1.800 € 4.780 €	09.11. - 16.11.2024 1.800 € 4.780 €
16.11. - 23.11.2024 4.780 €	23.11. - 01.03.2025 NOT AVAILABLE	01.03. - 08.03.2025 2.690 € 3.800 €	08.03. - 15.03.2025 2.690 € 3.800 €
15.03. - 22.03.2025 2.690 € 3.800 €	22.03. - 29.03.2025 2.690 € 3.800 €	29.03. - 05.04.2025 2.690 € 3.800 €	05.04. - 12.04.2025 2.690 € 3.800 €
12.04. - 26.04.2025 NOT AVAILABLE	26.04. - 03.05.2025 3.910 € 4.600 €		



WEBSITE
www.plujeme.cz



E-MAIL
info@plujeme.cz



PHONE
+420 720 755 085



PLUJEME RÁDI S.R.O.
Dlouhá 730/35, 11000 Praha 1 – Staré Město, Czech Republic



MOBILE
+420 777 170 276

PRICE AND AVAILABILITY

03.05. - 10.05.2025 3.910 € 4.600 €	10.05. - 17.05.2025 3.910 € 4.600 €	17.05. - 24.05.2025 4.500 € 6.000 €	24.05. - 31.05.2025 4.500 € 6.000 €
31.05. - 07.06.2025 4.500 € 6.000 €	07.06. - 14.06.2025 4.500 € 6.000 €	14.06. - 21.06.2025 4.875 € 6.500 €	21.06. - 28.06.2025 4.875 € 6.500 €
28.06. - 05.07.2025 5.525 € 6.500 €	05.07. - 12.07.2025 5.525 € 6.500 €	12.07. - 19.07.2025 NOT AVAILABLE	19.07. - 26.07.2025 5.850 € 6.500 €
26.07. - 02.08.2025 6.570 € 7.300 €	02.08. - 09.08.2025 6.205 € 7.300 €	09.08. - 16.08.2025 6.205 € 7.300 €	16.08. - 23.08.2025 5.525 € 6.500 €
23.08. - 30.08.2025 5.525 € 6.500 €	30.08. - 06.09.2025 5.525 € 6.500 €	06.09. - 13.09.2025 5.400 € 6.000 €	13.09. - 20.09.2025 5.400 € 6.000 €
20.09. - 27.09.2025 5.400 € 6.000 €	27.09. - 04.10.2025 4.140 € 4.600 €	04.10. - 11.10.2025 3.800 €	11.10. - 18.10.2025 3.800 €
18.10. - 25.10.2025 3.800 €	25.10. - 01.11.2025 3.800 €	01.11. - 08.11.2025 3.800 €	08.11. - 15.11.2025 3.800 €
15.11. - 22.11.2025 3.800 €	22.11. - 29.11.2025 3.800 €	29.11. - 06.12.2025 3.800 €	06.12. - 13.12.2025 3.800 €
13.12. - 20.12.2025 3.800 €	20.12. - 27.12.2025 3.800 €		



WEBSITE
www.plujeme.cz



E-MAIL
info@plujeme.cz



PHONE
+420 720 755 085



MOBILE
+420 777 170 276



PLUJEME RÁDI S.R.O.
Dlouhá 730/35, 11000 Praha 1 – Staré Město, Czech Republic