

QUEEN OF ADRIATIC

Queen of Adriatic (2008)

Gulet **Queen of Adriatic Queen of Adriatic**, built in **2008** is anchored in the **Kaštel Gomilica, Kaštilac, Split region, Croatia**. It has **6 cabins**, can accommodate **12 + 2 people** and has **6 toilets**. Bed linen and kitchen equipment are included in the price.

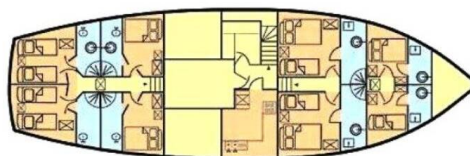

YACHT SPECIFICATIONS

Yacht Base

Kaštel Gomilica, Kaštilac, Croatia

Yacht ID

1095

Brands

Yener Yachts

Yacht name

Queen of Adriatic

Production year

2008

Length

89 ft

Cabins

6

Berths

12 + 2

WC

6

Engine

2 x 450 HP

Fuel tank

9000 l



WEBSITE

www.plujeme.cz



PHONE

+420 720 755 085



MOBILE

+420 777 170 276



E-MAIL

info@plujeme.cz



PLUJEME RÁDI S.R.O.

Dlouhá 730/35, 11000 Praha 1 – Staré Město, Czech Republic

STANDARD YACHT EQUIPMENT

Comfort	Bed linen, Blankets, Pillows, Sheets, Towels
Deck	Bar
Entertainment	Banana boat, Donut, Fishing equipment, Kayak, Radio CD player, Snorkeling equipment, Stand up paddle (SUP), TV + DVD, Water skis, Wi-Fi Internet
Yacht electrics	Air Conditioning, Battery charger , Generator



WEBSITE

www.plujeme.cz



E-MAIL

info@plujeme.cz



PHONE

+420 720 755 085



MOBILE

+420 777 170 276



PLUJEME RÁDI S.R.O.

Dlouhá 730/35, 11000 Praha 1 – Staré Město, Czech Republic

SERVICES

SELECTED SERVICES	OBLIGATORY	PAYMENT TYPE	PRICE
Half board (Payable at the base) Season: 2025. Excluding drinks Food for children under the age of 2: Free of charge Food for children under the age of 11: - 50%	Yes	per week/ person	500,00 €
Natural park fee (Payable at the base) Season: 2025. depending on attendance	Yes	per booking	0,00 €
Tourist tax (Payable at the base) Season: 2025.	Yes	per guest/night	2,00 €
AC generator running over 12h/day (Payable at the base) Season: 2025. running over 12h/day	No	per hour	20,00 €
All inclusive domestic non alcoholic package (Payable at the base) Season: 2025. Water, tea, coffee, juices	No	per week/ person	145,00 €
All inclusive domestic package (Payable at the base) Season: 2025. Includes Croatian-produced wine, beer, spirits, soft drinks, and hot beverages. *Special ordered wines or premium wines, foreign alcoholic drinks like vodka, whiskey, gin, champagnes etc., are extra cost if consumed	No	per week/ person	290,00 €
All inclusive package (Payable at the base) Season: 2025. soft drinks and hot beverages, beer, Croatian produced quality wine from boat bar list, also foreign spirits: Bombay Sapphire and Tanqueray gin, Absolut and Finlandia vodka, Johny Walker Red Label, Jameson, Sambuca, J. Cuervo Silver tequila, Amaretto, Vermouth, Jägermeister, Malibu, Aperol, Prosecco, Baileys. *All drinks not listed are not included and should be supplied and charged at special arrangement.	No	per week/ person	470,00 €
Corkage fee (Payable at the base) Season: 2025. If guests supply drinks and beverages, a Non-alcoholic drink supplement is obligatory and considered a corkage fee	No	per week/ person	145,00 €
Extra meal (Payable at the base) Season: 2025.	No	per person	45,00 €
Extra navigation (Payable at the base) Season: 2025. above 5h daily	No	per hour	70,00 €

Fuel consumption (Payable at the base)	No	per hour	80,00 €
Season: 2025. Fuel for water sports that use tender (water ski, donut, wakeboard, etc..)			
Full board (Payable at the base)	No	per week/ person	700,00 €
Season: 2025. excluding drinks			
One way (Payable at the base)	No	one-way	1.000,00 €
Season: 2025. to Dubrovnik (if empty leg caused)			
Parking (Payable at the base)	No	per week	70,00 €
Season: 2025. Please, contact marina for more details			



WEBSITE

www.plujeme.cz



E-MAIL

info@plujeme.cz



PHONE

+420 720 755 085



MOBILE

+420 777 170 276



PLUJEME RÁDI S.R.O.

Dlouhá 730/35, 11000 Praha 1 – Staré Město, Czech Republic

ADDITIONAL EXTRAS

EXTRA	OBLIGATORY	PAYMENT TYPE	PRICE
Jet Ski (Payable at the base) Season: 2025 + fuel - Payable at the base	No	per week	1.000,00 €



WEBSITE

www.plujeme.cz



E-MAIL

info@plujeme.cz



PHONE

+420 720 755 085



MOBILE

+420 777 170 276



PLUJEME RÁDI S.R.O.

Dlouhá 730/35, 11000 Praha 1 – Staré Město, Czech Republic

PRICE AND AVAILABILITY

04.01. - 11.01.2025 18.900 €	11.01. - 18.01.2025 18.900 €	18.01. - 25.01.2025 18.900 €	25.01. - 01.02.2025 18.900 €
01.02. - 08.02.2025 18.900 €	08.02. - 15.02.2025 18.900 €	15.02. - 22.02.2025 18.900 €	22.02. - 01.03.2025 18.900 €
01.03. - 08.03.2025 18.900 €	08.03. - 15.03.2025 18.900 €	15.03. - 22.03.2025 18.900 €	22.03. - 29.03.2025 18.900 €
29.03. - 05.04.2025 18.900 €	05.04. - 12.04.2025 18.900 €	12.04. - 19.04.2025 18.900 €	19.04. - 26.04.2025 18.900 €
26.04. - 03.05.2025 18.900 €	03.05. - 10.05.2025 18.900 €	10.05. - 17.05.2025 18.900 €	17.05. - 24.05.2025 18.900 €
24.05. - 31.05.2025 18.900 €	31.05. - 07.06.2025 18.900 €	07.06. - 14.06.2025 18.900 €	14.06. - 21.06.2025 23.900 €
21.06. - 28.06.2025 23.900 €	28.06. - 05.07.2025 23.900 €	05.07. - 12.07.2025 23.900 €	12.07. - 19.07.2025 23.900 €
19.07. - 26.07.2025 25.900 €	26.07. - 02.08.2025 25.900 €	02.08. - 09.08.2025 25.900 €	09.08. - 16.08.2025 25.900 €
16.08. - 23.08.2025 NOT AVAILABLE	23.08. - 30.08.2025 23.900 €	30.08. - 06.09.2025 23.900 €	



WEBSITE
www.plujeme.cz



E-MAIL
info@plujeme.cz



PHONE
+420 720 755 085



PLUJEME RÁDI S.R.O.
Dlouhá 730/35, 11000 Praha 1 – Staré Město, Czech Republic



MOBILE
+420 777 170 276

PRICE AND AVAILABILITY

06.09. - 13.09.2025 23.900 €	13.09. - 20.09.2025 18.900 €	20.09. - 27.09.2025 18.900 €	27.09. - 04.10.2025 18.900 €
04.10. - 11.10.2025 18.900 €	11.10. - 18.10.2025 18.900 €	18.10. - 25.10.2025 18.900 €	25.10. - 01.11.2025 18.900 €
01.11. - 08.11.2025 18.900 €	08.11. - 15.11.2025 18.900 €	15.11. - 22.11.2025 18.900 €	22.11. - 29.11.2025 18.900 €
29.11. - 06.12.2025 18.900 €	06.12. - 13.12.2025 18.900 €	13.12. - 20.12.2025 18.900 €	20.12. - 27.12.2025 18.900 €



WEBSITE

www.plujeme.cz



E-MAIL

info@plujeme.cz



PHONE

+420 720 755 085



MOBILE

+420 777 170 276



PLUJEME RÁDI S.R.O.

Dlouhá 730/35, 11000 Praha 1 – Staré Město, Czech Republic