

HANSE 548

Joy (2018)

Sailing yacht Hanse 548 Joy, built in 2018 is anchored in the Lefkas, D-Marin, Ionian Islands, Greece. It has 4 + 1 cabins, can accommodate 8 + 1 people and has 4 + 1 toilets. Bed linen and kitchen equipment are included in the price.

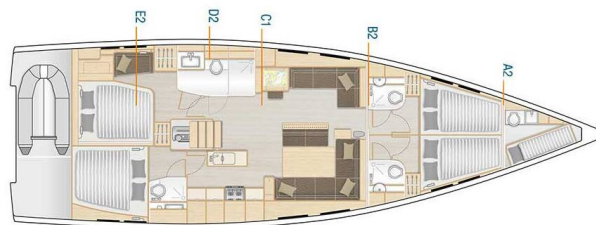

YACHT SPECIFICATIONS

Yacht Base

Lefkas, D-Marin, Greece

Yacht ID

1028

Brands

Hanse Yachts

Yacht name

Joy

Production year

2018

Length

53 ft

Cabins

4 + 1

Berths

8 + 1

Max Persons

10

WC

4 + 1

Engine

0 x 0 HP

Fuel tank

0 l



WEBSITE

www.plujeme.cz



PHONE

+420 720 755 085



MOBILE

+420 777 170 276



E-MAIL

info@plujeme.cz



PLUJEME RÁDI S.R.O.

Dlouhá 730/35, 11000 Praha 1 – Staré Město, Czech Republic

STANDARD YACHT EQUIPMENT

Comfort	Blankets, Pillows, Sheets, Towels
Deck	Anchor with chain, Bimini top, Boat hook, Dinghy with outboard engine, Gangway, Hydraulic gangway, Spare anchor (Reserve, Auxiliary anchor), Sprayhood, Swimming ladder, Water hose, Winch handles
Entertainment	Snorkeling equipment
Galley	Gas cookers, Hot water, Kitchen utensils (Galley equipment, cutlery), Refrigerator
Interior	Barometer, Electric toilet
Navigation	Autopilot, Binoculars, Bow thruster, Echosounder/Depthsounder, GPS chart plotter - cockpit, Hand bearing compass, Log/speed instrument, Nautical charts, Wind instrument/Anemometer
Safety	Distress flare box, Emergency tiller, Fire extinguisher , First aid kit , Fog horn, Life belts (Safety harness), Life jackets, Liferaft , Torch, VHF radio , Wire (shroud) cutter
Sails	Electric winch
Yacht electrics	Air Conditioning, Battery charger , Generator, Shore connection 220 V, USB sockets



WEBSITE

www.plujeme.cz



PHONE

+420 720 755 085



MOBILE

+420 777 170 276



E-MAIL

info@plujeme.cz









PLUJEME RÁDI S.R.O.

Dlouhá 730/35, 11000 Praha 1 – Staré Město, Czech Republic

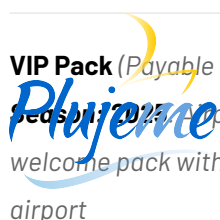
SERVICES

SELECTED SERVICES	OBLIGATORY	PAYMENT TYPE	PRICE
Standard Charter Pack (Payable at the base) Season: 2025. Welcome kit, final cleaning, bed sheets & towels (one set per person), first fill for outboard engine, spare bottle of gas	Yes	per booking	300,00 €
Beach towel (Payable at the base) Season: 2025.	No	per booking	10,00 €
Cabin conversion (Payable at the base) Season: 2025. If possible on yacht. Contact fleet operator for more information.	No	per booking	150,00 €
Cook (Payable at the base) Season: 2025. Crew provisioning to be provided by Charterer in arrangement with crew. If monetary compensation shall be agreed, then it shall be of no less than €30 per crew member per day. Charterer shall provide crew with sleeping cabin/berth and shower/toilet use to be designated to them onboard.	No	per day + food	200,00 €
Deposit insurance (Payable at the base) Season: 2025. + refundable 700 EUR, payable on spot in CASH	No	per week	400,00 €
Family pack (Payable at the base) Season: 2025. Safety net, SUP, junior life jackets, normal foam type	No	per booking	350,00 €
Fast Track pack (Payable at the base) Season: 2025. Access to the yacht by 14:00h on embarkation day, only IF feasible	No	per booking	180,00 €
Hostess (Payable at the base) Season: 2025. Crew provisioning to be provided by Charterer in arrangement with crew. If monetary compensation shall be agreed, then it shall be of no less than €30 per crew member per day. Charterer shall provide crew with sleeping cabin/berth and shower/toilet use to be designated to them onboard.	No	per day + food	180,00 €
Internet pack (Payable at the base) Season: 2025. Wi-Fi router for Internet aboard (subject to GSM coverage up to 10GB/week)	No	per week	50,00 €

One way fee (Payable at the base) Season: 2025. Volos-Skiathos	No	per booking	300,00 €
One way fee (Payable at the base) Season: 2025. Preveza-Lefkas	No	per booking	300,00 €
One way fee (Payable at the base) Season: 2025. Athens-Lavrion	No	per booking	400,00 €
One way fee (Payable at the base) Season: 2025. in-between Dodecanese or Ionian or Cyclades	No	per booking	500,00 €
One way fee (Payable at the base) Season: 2025. Athens-Cyclades/Sporades	No	per booking	800,00 €
One way fee (Payable at the base) Season: 2025. Athens-Dodecanese	No	per booking	1.200,00 €
One way fee (Payable at the base) Season: 2025. Athens-Ionian	No	per booking	1.900,00 €
Overnight on board (Payable at the base) Season: 2025. Embarkation on yacht & overnight stay the day before charter starts, check-in by 13:00h on charter start day. Subject to last minute availability of yacht on previous day.	No	per booking	180,00 €
Pet on board (Payable at the base) Season: 2025. up to 7 kg	No	per booking	200,00 €
Skipper (Payable at the base) Season: 2025. Crew provisioning to be provided by Charterer in arrangement with crew. If monetary compensation shall be agreed, then it shall be of no less than €30 per crew member per day. Charterer shall provide crew with sleeping cabin/berth and shower/toilet use to be designated to them onboard. Skipped charters come obligatorily with: Security deposit reduction, non refundable, EUR 350 payable in cash on spot plus Security deposit, refundable if not damage, EUR 700 via credit card.	No	per day + food	200,00 €
Stand up paddle (SUP) (Payable at the base) Season: 2025.	No	per week	100,00 €

 VIP Pack (Payable at the base) Season: 2025. Airport/Local Base welcome & pickup, transfer to the yacht, welcome pack with sparkling wine, fruits, departure transfer to local airport	 WEBSITE www.plujeme.cz	 PHONE No +420 720 755 085	 MOBILE per booking +420 777 170 276	300,00 €
	 E-MAIL info@plujeme.cz		 PLUJEME RÁDI S.R.O. Dlouhá 730/35, 11000 Praha 1 – Staré Město, Czech Republic	

ADDITIONAL EXTRAS

EXTRA	OBLIGATORY	PAYMENT TYPE	PRICE
Automatic Inflatable Life Jacket (Payable at the base) <i>Season: 2025. Payable at the base</i>	No	per week/ person	20,00 €
Beach towel (Payable at the base) <i>Season: 2025. Payable at the base</i>	No	per piece	10,00 €
Extra bedlinen (Payable at the base) <i>Season: 2025. Payable at the base</i>	No	per set	10,00 €
Gennaker (Payable at the base) <i>Season: 2025. + extra security deposit 500 EUR (refundable) - Payable at the base</i>	No	per week	200,00 €
Grill/Barbecue/Plancha (Payable at the base) <i>Season: 2025. portable, 1x gas bottle included - Payable at the base</i>	No	per week	80,00 €
Kayak (Payable at the base) <i>Season: 2025. Payable at the base</i>	No	per week	100,00 €
Railing net (Safety net) (Payable at the base) <i>Season: 2025. installed - Payable at the base</i>	No	per booking	200,00 €
Stand up paddle (SUP) (Payable at the base) <i>Season: 2025. Payable at the base</i>	No	per week	100,00 €



WEBSITE
www.plujeme.cz



E-MAIL
info@plujeme.cz



PHONE
+420 720 755 085



PLUJEME RÁDI S.R.O.
Dlouhá 730/35, 11000 Praha 1 – Staré Město, Czech Republic



MOBILE
+420 777 170 276

PRICE AND AVAILABILITY

02.01. - 22.03.2025 NOT AVAILABLE	22.03. - 29.03.2025 3.510 € 3.900 €	29.03. - 05.04.2025 3.510 € 3.900 €	05.04. - 12.04.2025 3.315 € 3.900 €
12.04. - 19.04.2025 3.315 € 3.900 €	19.04. - 26.04.2025 3.315 € 3.900 €	26.04. - 03.05.2025 3.825 € 4.500 €	03.05. - 10.05.2025 3.825 € 4.500 €
10.05. - 17.05.2025 4.675 € 5.500 €	17.05. - 24.05.2025 4.675 € 5.500 €	24.05. - 31.05.2025 NOT AVAILABLE	31.05. - 07.06.2025 6.035 € 7.100 €
07.06. - 14.06.2025 6.035 € 7.100 €	14.06. - 21.06.2025 6.035 € 7.100 €	21.06. - 28.06.2025 NOT AVAILABLE	28.06. - 05.07.2025 7.225 € 8.500 €
05.07. - 12.07.2025 7.225 € 8.500 €	12.07. - 19.07.2025 7.565 € 8.900 €	19.07. - 26.07.2025 7.565 € 8.900 €	26.07. - 02.08.2025 NOT AVAILABLE



WEBSITE

www.plujeme.cz



E-MAIL

info@plujeme.cz



PHONE

+420 720 755 085



MOBILE

+420 777 170 276



PLUJEME RÁDI S.R.O.

Dlouhá 730/35, 11000 Praha 1 – Staré Město, Czech Republic

PRICE AND AVAILABILITY

02.08. - 09.08.2025 8.670 € 10.200 €	09.08. - 16.08.2025 8.670 € 10.200 €	16.08. - 23.08.2025 8.670 € 10.200 €	23.08. - 30.08.2025 7.310 € 8.600 €
30.08. - 06.09.2025 7.740 € 8.600 €	06.09. - 13.09.2025 7.740 € 8.600 €	13.09. - 20.09.2025 6.930 € 7.700 €	20.09. - 27.09.2025 6.930 € 7.700 €
27.09. - 04.10.2025 5.310 € 5.900 €	04.10. - 11.10.2025 NOT AVAILABLE	11.10. - 18.10.2025 5.015 € 5.900 €	18.10. - 25.10.2025 3.740 € 4.400 €
25.10. - 01.11.2025 3.740 € 4.400 €	01.11. - 08.11.2025 3.740 € 4.400 €	08.11. - 15.11.2025 3.740 € 4.400 €	15.11. - 22.11.2025 3.960 € 4.400 €
22.11. - 29.11.2025 3.960 € 4.400 €	29.11. - 06.12.2025 3.960 € 4.400 €	06.12. - 13.12.2025 3.960 € 4.400 €	13.12. - 20.12.2025 3.960 € 4.400 €
20.12. - 27.12.2025 3.960 € 4.400 €			



WEBSITE
www.plujeme.cz



E-MAIL
info@plujeme.cz



PHONE
+420 720 755 085



MOBILE
+420 777 170 276



PLUJEME RÁDI S.R.O.
Dlouhá 730/35, 11000 Praha 1 – Staré Město, Czech Republic