

AKIN A

Akin A (1989)

Gulet Akin A Akin A, built in **1989** is anchored in the **Porto Montenegro, Montenegro, Montenegro**. It has **4 cabins**, can accommodate **12 people** and has **5 toilets**. Bed linen and kitchen equipment are included in the price.

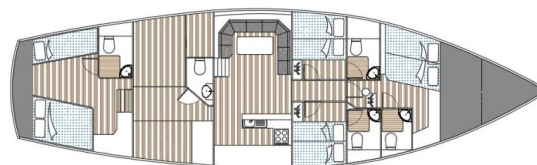

YACHT SPECIFICATIONS

Yacht Base

Porto Montenegro, Montenegro

Yacht ID

10112

Brands

Custom Made

Yacht name

Akin A

Production year

1989

Length

69 ft

Cabins

4

Berths

12

WC

5

Engine

0 x 0 HP

Fuel tank

2000 l



WEBSITE

www.plujeme.cz



PHONE

+420 720 755 085



MOBILE

+420 777 170 276



E-MAIL

info@plujeme.cz



PLUJEME RÁDI S.R.O.

Dlouhá 730/35, 11000 Praha 1 – Staré Město, Czech Republic

STANDARD YACHT EQUIPMENT

Additional	Grey Water Tank
Comfort	Bed linen, Blankets, Pillows, Sundeck cushions
Deck	Anchor with chain, Bimini top, Cockpit table, Cockpit/stern, outside shower, Dinghy with outboard engine, Electric anchor windlass, Gangway, Spare anchor (Reserve, Auxiliary anchor), Sprayhood
Entertainment	LCD TV, Outdoor speakers, Radio
Galley	Dishwasher, Electrical filter coffee maker, Freezer, Gas bottles, Gas cookers, Hot water, Kitchen utensils (Galley equipment, cutlery), Oven, Refrigerator
Navigation	AIS, Binoculars, Compass, Echosounder/Depthsounder, GPS chart plotter, Nautical charts, Pilot book, Radar reflector, Wind instrument/Anemometer, Wind/speed/depth instruments
Safety	Bilge alarm, Black Water Tank, Buoyant smoke signal, Distress flare box, Fire blanket, Fire extinguisher, Floating light, Horseshoe lifebuoy, Life jackets, Liferaft, Smoke detector, VHF radio
Yacht electrics	12V Socket, Battery charger, Bilge pump - Electric, Generator, Inverter, Service batteries, Shore connection 220 V, Solar panels, Start battery, USB sockets, Watermaker - desalinator



WEBSITE

www.plujeme.cz



PHONE

+420 720 755 085



MOBILE

+420 777 170 276



E-MAIL

info@plujeme.cz



PLUJEME RÁDI S.R.O.

Dlouhá 730/35, 11000 Praha 1 – Staré Město, Czech Republic

SERVICES

SELECTED SERVICES	OBLIGATORY	PAYMENT TYPE	PRICE
Crew (Payable at the base) Season: 2025. A crew member is on board in the role of Host and support. Not Skipper!	Yes	per booking	0,00 €
Handling fees (Payable at the base) Season: 2025.	Yes	per booking	40,00 €
Transit log (Payable at the base) Season: 2025.	Yes	per booking	100,00 €
Cook (Payable at the base) Season: 2025.	No	per day + food	160,00 €
Crew change (Payable at the base) Season: 2025. Crew changes are possible during the charter, but will result in an extra charge of 250 euros. This fee includes administrative costs, fresh bed linens and towels, and one night at the pontoon. However, cleaning and Transit log changes are not part of this fee.	No	per crew change	250,00 €
Extra cleaning (Payable at the base) Season: 2025.	No	per booking	300,00 €
Hostess (Payable at the base) Season: 2025.	No	per day + food	150,00 €
Outboard fuel & Gas (Payable at the base) Season: 2025. 5 Liters	No	per service	8,00 €
Starter pack (Payable at the base) Season: 2025. The pack Consist : 1 gallon water (or 4 bottles of 1.5L),1 bottle of disinfectant, 1 small bottle of washing up liquid, 1 dish cloth, 1 sponge, garbage bags, 1 roll of paper towels, 1 box of matches, 1 roll of toilet paper in each head)	No	per pack	30,00 €
Transfer (Payable at the base) Season: 2025. Our transfer service is provided by a third party and rates can fluctuate based on seasonality and demand. Kindly reach out to us for the most accurate pricing before your trip. Payment can be made in cash or by credit card at the time of service.	No	per booking	0,00 €

WI-FI Internet connection on boat (Payable at the base)

No

per service

50,00 €

Season: 2025. per 250Gb



WEBSITE

www.plujeme.cz



E-MAIL

info@plujeme.cz



PHONE

+420 720 755 085



MOBILE

+420 777 170 276



PLUJEME RÁDI S.R.O.

Dlouhá 730/35, 11000 Praha 1 – Staré Město, Czech Republic

ADDITIONAL EXTRAS

EXTRA	OBLIGATORY	PAYMENT TYPE	PRICE
Coffee machine (Payable at the base) Season: 2025. Payable at the base	No	per week	50,00 €
Extra bedlinen (Payable at the base) Season: 2025. Set consists of 2 sheets & 2 pillow case - Payable at the base	No	per set	10,00 €
Extra towels (Payable at the base) Season: 2025. 1 Big + 1 Small - Payable at the base	No	per set	8,00 €
Grill/Barbecue/Plancha (Payable at the base) Season: 2025. Payable at the base	No	per week	50,00 €

**WEBSITE**www.plujeme.cz**E-MAIL**info@plujeme.cz**PHONE**

+420 720 755 085

**MOBILE**

+420 777 170 276

**PLUJEME RÁDI S.R.O.**

Dlouhá 730/35, 11000 Praha 1 – Staré Město, Czech Republic

PRICE AND AVAILABILITY

01.01. - 31.05.2025

NOT AVAILABLE

07.06. - 14.06.2025

11.400 € 12.000 €

14.06. - 21.06.2025

11.400 € 12.000 €

21.06. - 28.06.2025

11.400 € 12.000 €

28.06. - 05.07.2025

11.889 € 12.514 €



WEBSITE

www.plujeme.cz



E-MAIL

info@plujeme.cz



PHONE

+420 720 755 085



MOBILE

+420 777 170 276



PLUJEME RÁDI S.R.O.

Dlouhá 730/35, 11000 Praha 1 – Staré Město, Czech Republic

PRICE AND AVAILABILITY

05.07. - 12.07.2025 12.255 € 12.900 €	12.07. - 19.07.2025 12.255 € 12.900 €	19.07. - 26.07.2025 12.255 € 12.900 €	26.07. - 02.08.2025 12.255 € 12.900 €
02.08. - 09.08.2025 12.255 € 12.900 €	09.08. - 16.08.2025 12.255 € 12.900 €	16.08. - 23.08.2025 12.255 € 12.900 €	23.08. - 30.08.2025 12.255 € 12.900 €
30.08. - 06.09.2025 11.305 € 11.900 €	06.09. - 13.09.2025 10.925 € 11.500 €	13.09. - 20.09.2025 10.925 € 11.500 €	20.09. - 27.09.2025 10.925 € 11.500 €
27.09. - 04.10.2025 10.925 € 11.500 €	04.10. - 11.10.2025 10.925 € 11.500 €	11.10. - 18.10.2025 10.925 € 11.500 €	18.10. - 25.10.2025 10.925 € 11.500 €
01.11. - 31.12.2025 NOT AVAILABLE			



WEBSITE

www.plujeme.cz



E-MAIL

info@plujeme.cz



PHONE

+420 720 755 085



MOBILE

+420 777 170 276



PLUJEME RÁDI S.R.O.

Dlouhá 730/35, 11000 Praha 1 – Staré Město, Czech Republic