

# ISLAND CRUISING BOAT

MYrtillus (2025)

Motor yacht Island Cruising Boat MYrtillus, built in 2025 is anchored in the **BVI, Hodge's Creek Marina, British Virgin Islands, British Virgin Islands**. It has **4 + 1 cabins**, can accommodate **8 + 1 people** and has **4 + 1 toilets**. Bed linen and kitchen equipment are included in the price.

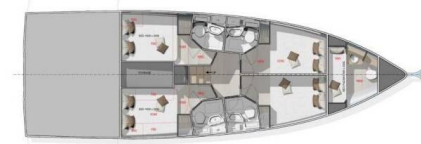

## YACHT SPECIFICATIONS

Yacht Base

**BVI, Hodge's Creek Marina, British Virgin Islands**

Yacht ID

**10043**

Brands

**Beneteau**

Yacht name

**MYrtillus**

Production year

**2025**

Length

**49 ft**

Cabins

**4 + 1**

Berths

**8 + 1**

Max Persons

**9**

WC

**4 + 1**

Engine

**2 x 15 HP**

Fuel tank

**200 l**



**WEBSITE**

[www.plujeme.cz](http://www.plujeme.cz)



**PHONE**

+420 720 755 085



**MOBILE**

+420 777 170 276



**E-MAIL**

[info@plujeme.cz](mailto:info@plujeme.cz)



**PLUJEME RÁDI S.R.O.**

Dlouhá 730/35, 11000 Praha 1 – Staré Město, Czech Republic

## STANDARD YACHT EQUIPMENT

Deck	<b>Anchor, Bilge pump – Mechanic, Cockpit/stern, outside shower, Dinghy with outboard engine, Electric anchor windlass, Foredeck sunbathing area, Gangway, Grill/Barbecue/Plancha, Mooring ropes , Spare anchor (Reserve, Auxiliary anchor)</b>
Entertainment	<b>Fusion radio</b>
Galley	<b>Gas bottles, Gas cookers, Ice maker, Oven, Refrigerator, Sink</b>
Interior	<b>Dining table, Electric fans in cabins, Electric toilet</b>
Navigation	<b>Autopilot, GPS chart plotter, Navigation (Nautical) charts and nautical guide , Navigation set</b>
Safety	<b>VHF radio</b>
Yacht electrics	<b>110V socket, Air Conditioning, Bilge pump – Electric, Generator, Inverter, Service batteries, Solar panels, USB sockets</b>



#### WEBSITE

[www.plujeme.cz](http://www.plujeme.cz)



#### E-MAIL

[info@plujeme.cz](mailto:info@plujeme.cz)



#### PHONE

+420 720 755 085



#### MOBILE

+420 777 170 276



#### PLUJEME RÁDI S.R.O.

Dlouhá 730/35, 11000 Praha 1 – Staré Město, Czech Republic

## SERVICES

SELECTED SERVICES	OBLIGATORY	PAYMENT TYPE	PRICE
<b>BVI Cruising Tax</b> (Payable at the base) <b>Season: 2026 Exotic.</b> Payment in cash only	Yes	per guest/day	<b>3,64 €</b>
<b>Final cleaning</b> (Payable now) <b>Season: 2026 Exotic.</b>	Yes	per booking	<b>340,00 €</b>
<b>Handling fees</b> (Payable now) <b>Season: 2026 Exotic.</b>	Yes	per booking	<b>35,00 €</b>
<b>National parks permit</b> (Payable at the base) <b>Season: 2026 Exotic.</b> US \$ 25.-/boat/week/up to 4 persons US \$ 35.- /boat/week/up to 6 persons US \$ 45.-/boat/week/up to 8 persons US \$ 55.- /boat/week/up to 10 persons US \$ 5.-/week for any additional person Payment in cash only / Foreign based boats pay twice those amounts All above taxes and fees are payable on spot and subject to change without notice	Yes	per week	<b>0,00 €</b>
<b>Search &amp; Sea rescue</b> (Payable at the base) <b>Season: 2026 Exotic.</b> 5 US \$ per person / Payment in cash only	Yes	per person	<b>4,55 €</b>
<b>Starter pack</b> (Payable now) <b>Season: 2026 Exotic.</b> The pack includes: 1 gallon water (or 4 bottles of 1.5L), 1 bottle of disinfectant, 1 small bottle of washing up liquid, 1 dish cloth, 1 sponge, garbage bags, 1 roll of paper towels, 1 box of matches, 1 roll of toilet paper in each head	Yes	per booking	<b>50,00 €</b>
<b>Charge for last minute change</b> (Payable at the base) <b>Season: 2026 Exotic.</b> Any last minute change 3 days or less of passenger information will be charged: 80 € per booking	No	per booking	<b>80,00 €</b>
<b>Crew change</b> (Payable now) <b>Season: 2026 Exotic.</b> Any crew change during the charter is subject to € 200.- additional cost. The charge includes administration cost, change of bed linen and towels and one night at DYC ponton (marina fee included only if the same base than start base). It doesn't include cleaning, nor new transit log where applicable.	No	per booking	<b>200,00 €</b>
<b>Early boarding/check-in</b> (Payable now) <b>Season: 2026 Exotic.</b> EB (boat only) - 14:00 h / 2 PM starting time of boat's delivery // limited number of early boardings on same departure day	No	per booking	<b>450,00 €</b>

<b>Early boarding/check-in</b> (Payable now)	No	per booking	<b>690,00 €</b>
<b>Season: 2026 Exotic.</b> EB boat + extra fee skipper - 14:00 h / 2 PM starting time of boat's delivery // limited number of early boardings on same departure day			
<b>Early boarding/check-in</b> (Payable now)	No	per booking	<b>890,00 €</b>
<b>Season: 2026 Exotic.</b> EB + extra fee Skipper & Hostes - 14:00 h / 2 PM starting time of boat's delivery // limited number of early boardings on same departure day			
<b>Electric &amp; Water consumption in the Marinas</b> (Payable at the base)	No	per booking	<b>28,00 €</b>
<b>Season: 2026 Exotic.</b> Electric & Water consumption based on 2 nights on our dock (base will confirm the amount to pay locally depending on nights spent on dock)			
<b>Extra set of linen (choose how many)</b> (Payable now)	No	per booking	<b>15,00 €</b>
<b>Season: 2026 Exotic.</b> Extra set of linen : 15 € 1 set of linen (2 sheets & 2 pillow case) - to be updated manually			
<b>Extra set of towels (choose how many)</b> (Payable now)	No	per booking	<b>10,00 €</b>
<b>Season: 2026 Exotic.</b> Extra set of towels: 10 € 1 set of towels (1 face & 1 bath towel) - to be updated manually			
<b>Full board 1-4 pax (number of guests to update manually)</b> (Payable now)	No	per guest/day	<b>65,00 €</b>
<b>Season: 2026 Exotic.</b> only available if cook is booked on board as the cook will do the provisioning based on client's preference. Includes breakfast, lunch & dinner + the crew's food. Does not included alcoholic drinks			
<b>Full board 5-12 pax (number of guests to update manually)</b> (Payable now)	No	per guest/day	<b>60,00 €</b>
<b>Season: 2026 Exotic.</b> only available if cook is booked on board as the cook will do the provisioning based on client's preference. Includes breakfast, lunch & dinner + the crew's food. Does not included alcoholic drinks			
<b>Half board 1-4 pax (number of guests to update manually)</b> (Payable now)	No	per guest/day	<b>55,00 €</b>
<b>Season: 2026 Exotic.</b> only available if cook is booked on board as the cook will do the provisioning based on client's preference. Includes breakfast & lunch OR dinner + the crew's food. Does not included alcoholic drinks			
<b>Half board 5-12 pax (number of guests to update manually)</b> (Payable now)	No	per guest/day	<b>50,00 €</b>
<b>Season: 2026 Exotic.</b> only available if cook is booked on board as the cook will do the provisioning based on client's preference. Includes breakfast & lunch OR dinner + the crew's food. Does not included alcoholic drinks			
<b>Hostess</b> (Payable now)	No	per night	<b>200,00 €</b>
<b>Season: 2026 Exotic.</b> + provisioning, a cabin or forepeak to sleep and access to a WC/Shower			

<b>Regatta surcharge</b> (Payable now)	No	per booking	<b>0,00 €</b>
<b>Season: 2026 Exotic.</b> all the regattas apart of ASW (different regatta surcharge for ASW) // A special race deposit need to be doubled manually once the regatta surcharge is added.			
<b>Regatta surcharge</b> (Payable now)	No	per booking	<b>2.050,00 €</b>
<b>Season: 2026 Exotic.</b> valid for ASW regatta only // A special race deposit need to be doubled manually once the regatta surcharge is added.			
<b>Skipper</b> (Payable now)	No	per night	<b>240,00 €</b>
<b>Season: 2026 Exotic.</b> + provisioning, a cabin or forepeak to sleep and access to a WC/Shower			
<b>Transfer</b> (Payable now)	No	one-way	<b>14,55 €</b>
<b>Season: 2026 Exotic.</b> OW - each additional pax from Road Town ferry or Tortola airport			
<b>Transfer</b> (Payable now)	No	round trip	<b>29,09 €</b>
<b>Season: 2026 Exotic.</b> RT - each additional pax from Road Town ferry or Tortola airport			
<b>Transfer</b> (Payable now)	No	one-way	<b>29,09 €</b>
<b>Season: 2026 Exotic.</b> OW - 1-2pax from Road Town ferry or Tortola airport.			
<b>Transfer</b> (Payable now)	No	round trip	<b>58,18 €</b>
<b>Season: 2026 Exotic.</b> RT - 1-2pax from Road Town ferry or Tortola airport.			



**WEBSITE**

[www.plujeme.cz](http://www.plujeme.cz)



**PHONE**

+420 720 755 085



**MOBILE**

+420 777 170 276



**E-MAIL**

[info@plujeme.cz](mailto:info@plujeme.cz)



**PLUJEME RÁDI S.R.O.**

Dlouhá 730/35, 11000 Praha 1 – Staré Město, Czech Republic

## ADDITIONAL EXTRAS

EXTRA	OBLIGATORY	PAYMENT TYPE	PRICE
<b>Kayak single</b> (Payable now) <b>Season: 2026 Exotic.</b> price per day - Additional deposit 100 EUR - Payable now	No	per night	<b>15,00 €</b>
<b>Kayak tandem</b> (Payable now) <b>Season: 2026 Exotic.</b> price per day - Additional deposit 100 EUR - Payable now	No	per night	<b>15,00 €</b>
<b>Railing net (Safety net)</b> (Payable now) <b>Season: 2026 Exotic.</b> net is supplied but not installed - Payable now	No	per booking	<b>250,00 €</b>
<b>Stand up paddle (SUP)</b> (Payable now) <b>Season: 2026 Exotic.</b> Price per day - Additional deposit 100 EUR - Payable now	No	per night	<b>15,00 €</b>



**WEBSITE**

[www.plujeme.cz](http://www.plujeme.cz)



**E-MAIL**

[info@plujeme.cz](mailto:info@plujeme.cz)



**PHONE**

+420 720 755 085



**MOBILE**

+420 777 170 276



**PLUJEME RÁDI S.R.O.**

Dlouhá 730/35, 11000 Praha 1 – Staré Město, Czech Republic

## PRICE AND AVAILABILITY

29.11. - 09.01.2025 NOT AVAILABLE	10.01. - 11.01.2025 NOT AVAILABLE	12.01. - 24.01.2025 NOT AVAILABLE	25.01. - 01.02.2025 <b>4.907 €</b> 7.010 €
01.02. - 08.02.2025 <b>5.558 €</b> 7.940 €	08.02. - 15.02.2025 <b>5.677 €</b> 8.110 €	15.02. - 22.02.2025 <b>5.681 €</b> 8.115 €	22.02. - 01.03.2025 <b>5.677 €</b> 8.110 €
01.03. - 08.03.2025 <b>6.493 €</b> 9.275 €	08.03. - 15.03.2025 <b>6.206 €</b> 8.865 €	15.03. - 22.03.2025 <b>5.586 €</b> 7.980 €	22.03. - 29.03.2025 <b>5.534 €</b> 7.905 €
29.03. - 05.04.2025 <b>5.292 €</b> 7.560 €	05.04. - 12.04.2025 <b>4.774 €</b> 6.820 €	12.04. - 19.04.2025 <b>5.404 €</b> 7.720 €	19.04. - 26.04.2025 <b>5.376 €</b> 7.680 €
26.04. - 03.05.2025 <b>4.837 €</b> 6.910 €	03.05. - 10.05.2025 <b>4.036 €</b> 5.765 €	10.05. - 17.05.2025 <b>4.036 €</b> 5.765 €	17.05. - 24.05.2025 <b>4.211 €</b> 6.015 €
24.05. - 31.05.2025 <b>4.389 €</b> 6.270 €	31.05. - 07.06.2025 <b>4.407 €</b> 6.295 €	07.06. - 14.06.2025 <b>4.407 €</b> 6.295 €	14.06. - 21.06.2025 <b>4.407 €</b> 6.295 €
21.06. - 28.06.2025 <b>4.407 €</b> 6.295 €	28.06. - 05.07.2025 <b>5.980 €</b> 6.295 €		



WEBSITE

[www.plujeme.cz](http://www.plujeme.cz)



E-MAIL

[info@plujeme.cz](mailto:info@plujeme.cz)



PHONE

+420 720 755 085



MOBILE

+420 777 170 276



PLUJEME RÁDI S.R.O.

Dlouhá 730/35, 11000 Praha 1 – Staré Město, Czech Republic

## PRICE AND AVAILABILITY

05.07. - 12.07.2025 <b>5.957 €</b> 6.270 €	12.07. - 19.07.2025 <b>5.477 €</b> 5.765 €	19.07. - 26.07.2025 <b>5.477 €</b> 5.765 €	26.07. - 02.08.2025 <b>5.249 €</b> 5.525 €
02.08. - 09.08.2025 <b>4.460 €</b> 4.695 €	09.08. - 16.08.2025 <b>4.460 €</b> 4.695 €	16.08. - 23.08.2025 <b>3.943 €</b> 4.150 €	23.08. - 30.08.2025 <b>3.078 €</b> 3.240 €
30.08. - 06.09.2025 <b>3.078 €</b> 3.240 €	06.09. - 13.09.2025 <b>3.078 €</b> 3.240 €	13.09. - 20.09.2025 <b>3.078 €</b> 3.240 €	20.09. - 27.09.2025 <b>3.078 €</b> 3.240 €
27.09. - 04.10.2025 <b>3.078 €</b> 3.240 €	04.10. - 11.10.2025 <b>3.183 €</b> 3.350 €	11.10. - 18.10.2025 <b>3.691 €</b> 3.885 €	18.10. - 25.10.2025 <b>4.209 €</b> 4.430 €
25.10. - 01.11.2025 <b>4.465 €</b> 4.700 €	01.11. - 08.11.2025 <b>5.168 €</b> 5.440 €	08.11. - 15.11.2025 <b>5.410 €</b> 5.695 €	15.11. - 22.11.2025 <b>5.695 €</b> 5.995 €
22.11. - 29.11.2025 <b>6.265 €</b> 6.595 €	29.11. - 06.12.2025 <b>5.743 €</b> 6.045 €	06.12. - 13.12.2025 <b>5.282 €</b> 5.560 €	13.12. - 20.12.2025 <b>5.282 €</b> 5.560 €
20.12. - 27.12.2025 <b>9.339 €</b> 9.830 €			



**WEBSITE**  
[www.plujeme.cz](http://www.plujeme.cz)



**E-MAIL**  
[info@plujeme.cz](mailto:info@plujeme.cz)



**PHONE**  
+420 720 755 085



**PLUJEME RÁDI S.R.O.**  
Dlouhá 730/35, 11000 Praha 1 – Staré Město, Czech Republic



**MOBILE**  
+420 777 170 276